



- Round cap
- Ø9.6 mm
- h =10.4 mm
- Material: ABS/polycarbonate
- Temp. Range:
  - Solid cap: -40/+65°C
  - Transparent cap: -40/+85°C
- Panel cut-out: 1JS-Ø10.4

\*Legends on the picture are custom

All dimensions in mm

Tolerances +/-0.2mm

## DIMENSIONS

### TH + 1JS

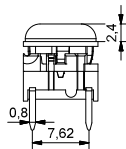
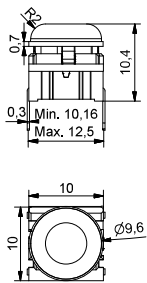

### SMD w/LED + 1JS

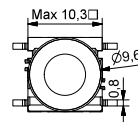
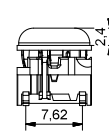
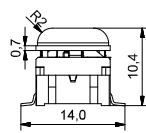

## ILLUMINATED – HOW TO ORDER

| Switch | Mounting   | Actuation force  | LED  | + | Cap transparent | Colour code                                       |
|--------|--|--|--|---|-----------------|---|
| 5 G    | <input type="checkbox"/> <input type="checkbox"/> <input type="checkbox"/> | <input type="checkbox"/> <input type="checkbox"/> <input type="checkbox"/> | <input type="checkbox"/> <input type="checkbox"/> <input type="checkbox"/> <input type="checkbox"/>              | + | 1 J S           | <input type="checkbox"/> <input type="checkbox"/> |
|        | TH9 through-hole<br>SH9 surface mount                                      | 20<br>35<br>65<br>Q*   | 02 blue<br>22 green<br>42 yellow<br>61 white<br>82 red<br>2242 green/yellow<br>8222 red/green<br>8242 red/yellow |   |                 | 11 transparent<br>16 frosted white                |

## NON-ILLUMINATED – HOW TO ORDER

| Switch | Mounting   | Actuation force  | + | Cap solid colour | Colour code   |
|--------|--|--|---|------------------|---|
| 5 G    | <input type="checkbox"/> <input type="checkbox"/> <input type="checkbox"/> | <input type="checkbox"/> <input type="checkbox"/> <input type="checkbox"/> | + | 1 J S            | <input type="checkbox"/> <input type="checkbox"/>                             |
|        | TH9 through-hole<br>SH9 surface mount                                      | 20<br>20Q<br>35<br>65  |   |                  | 00 blue<br>02 green<br>03 grey<br>04 yellow<br>06 white<br>08 red<br>09 black |

Ordering example:  
5GTH935+1JS08 without illumination OR 5GTH93501+1JS16 with illumination OR \*5GTH92001Q (illuminated quiet version)